

# **First Class Orienteering Course**

## **Codman Estate South Lincoln, MA**

**F. John Solman**

**Troop 127**

**16 February 2006**

**Rev 13 June 2011**

**“I’d rather be approximately right than precisely wrong.”**

**--- Peter Drucker**

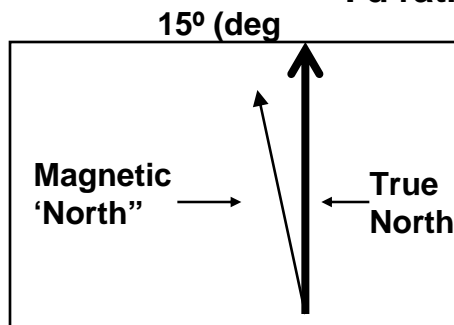

# First Class Orienteering Course Req: “F2”

- Using a compass, complete an orienteering course that covers at least one mile and requires measuring the height and or width of designated items (tree, tower, canyon ditch, etc.)
- Magnetic Declination at Lincoln, MA as of 1987 was ~15 degrees.

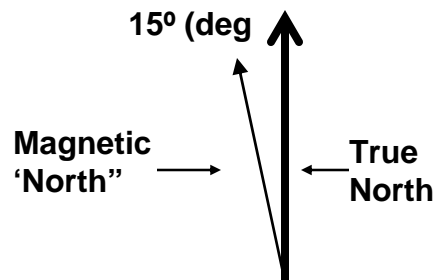

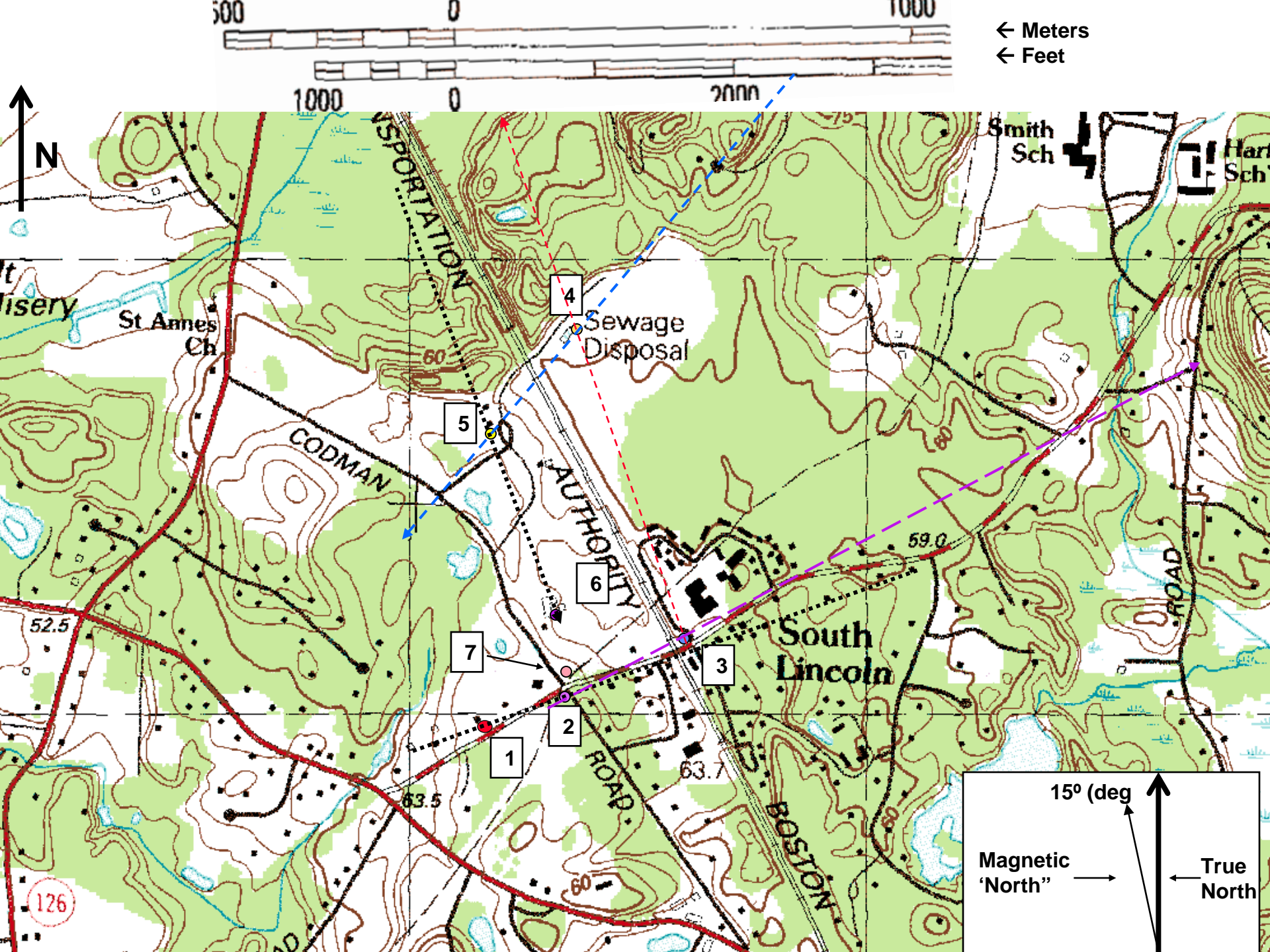

# Clues to Course Landmarks

- 1.) Start Point is fire hydrant across street from Mason's Hall
- 2.) A stone box for watering horses
- 3.) Gate post on NE side of tracks
- 4.) North corner of enclosure
- 5.) SE corner of Large house
- 6.) SE corner of fence at top of driveway to lower barnyard
- 7.) A small white Building recently painted by a 127 Eagle

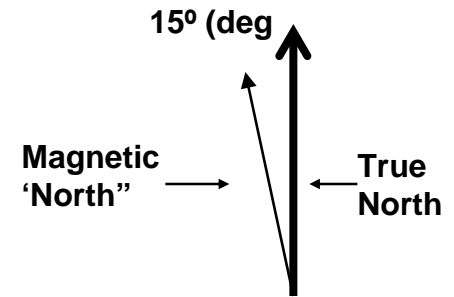

Use map on previous page. Use compass as protractor to measure bearing angles from true north for items underlined  
Use cm scale on ruler to estimate distance between points and convert to feet by using map scale at top of map

Landmark N to N +1	Bearing from True North; distance	Bearing from Mag North		Reciprocal True N (add or subtract 180 degrees)	Reciprocal Magnetic North	Comments
1 → 2 Ex:	72 deg 640 ft		1 ← 2	252 deg		I see you, you see me
2 → 3			2 ← 3			
<u>3 → 4</u>			<u>3 ← 4</u>			
4 → 5			4 ← 5			
<u>5 → 6</u>			<u>5 ← 6</u>			
6 → 7			6 ← 7			





Map    Satellite    Hybrid

Aerial Photo  
(High Res map!)  
Of orienteering  
Course.

SEG#4

SEG#3

SEG#5

SEG#6

SEG#2

SEG#1

